

CDLF 1, 2, 3, 4

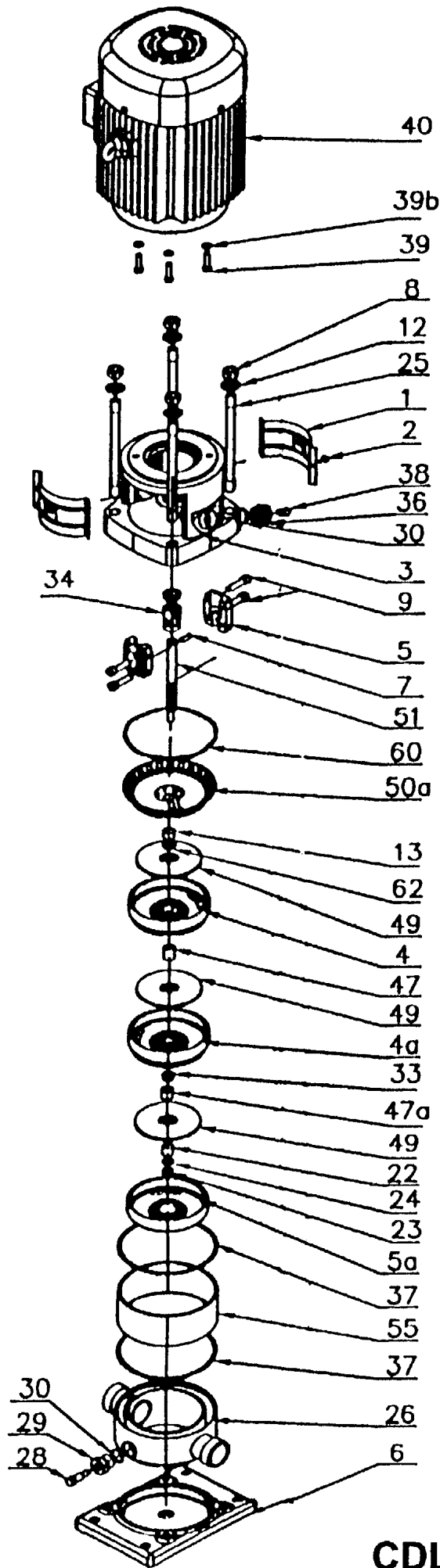

1. Coupling guard
2. Screw for coupling guard
3. Pump head
4. Diffuser
- 4a. Support diffuser
5. Coupling
- 5a. Inducer
6. Base plate
7. Shaft pin
8. Nut for staybolt
9. Screw for coupling
12. Washer for staybolt
13. Circlip cover
22. Impeller cover
23. Nut for impeller
24. Washer for impeller
25. Stay bolt
26. Inler & Outlet chamber
28. Vent plug screw
29. Drainage nut
30. O-ring for drainage
33. Support sleeve
34. Mechanical seal
36. Air plug nut
37. Gasket
38. Air plug screw
39. Screw for motor
- 39b. Washer for motor
40. Motor
47. Impeller sleeve
- 47a. Bearing
49. Impeller
- 50a. Top Diffuser
51. Shaft
55. Cylinder
60. Spring
62. Seal sleeve (CDL4 only)

CDL 1,2,3,4 (Old Structure)

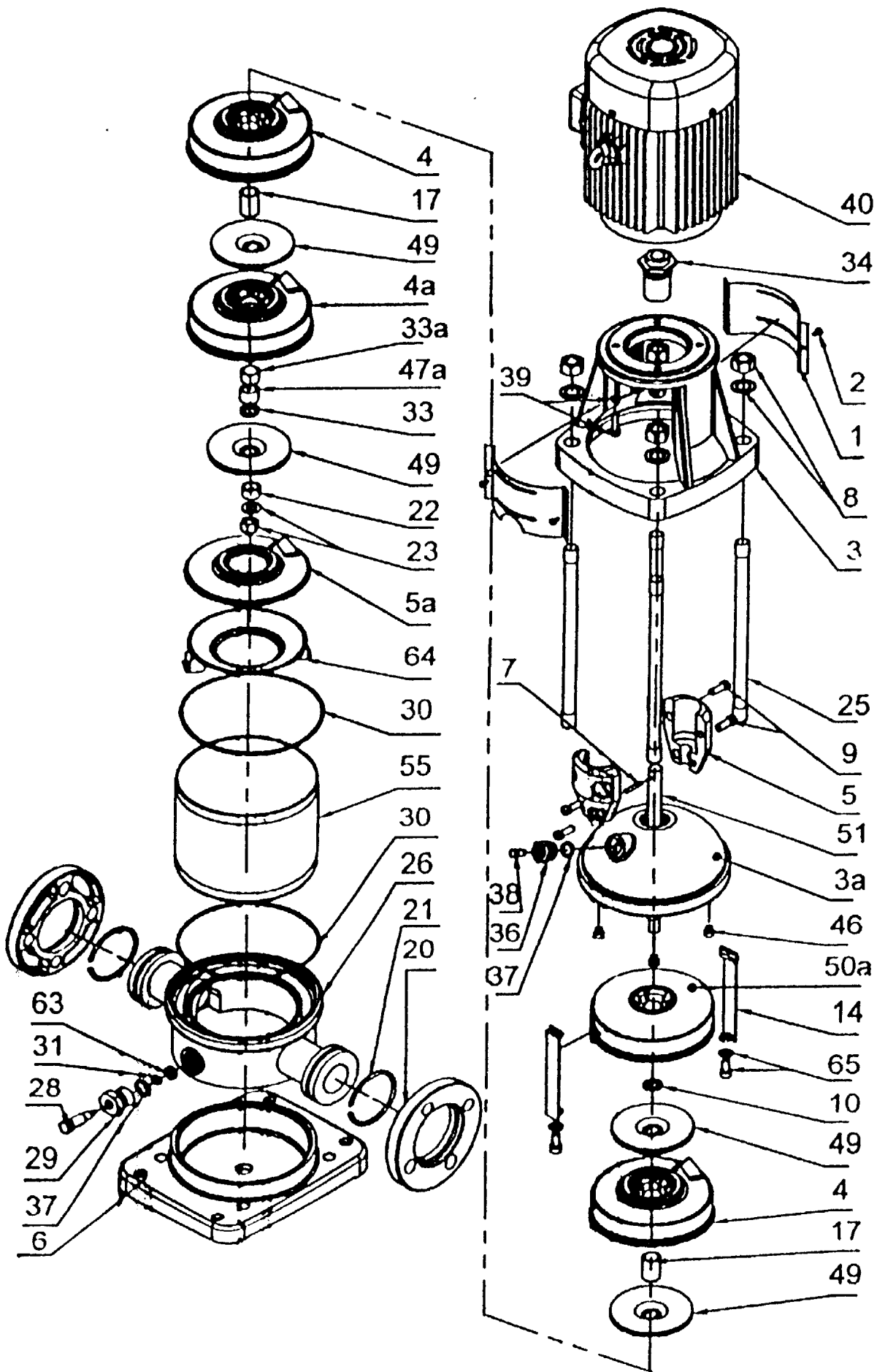

1. Cover
2. Screw M4x8
3. Pump head
- 3a. Lining
4. Diffuser
- 4a. Support diffuser
5. Coupling
- 5a. Inducer
6. Base
7. Shaft pin
8. Nut M16, washer16
9. Screw
10. Stop ring
14. Strap
17. Sleeve 1
20. Flange
21. Circlip
22. Sleeve 3
23. Nut M12, washer 12
25. Staybolt
26. Suction & Discharge
28. Drainage
29. Drainage
30. O-ring 169x3.3
31. O-ring 8x2.65
33. Sleeve
- 33a. Sleeve 2
34. Mechanical seal
36. Air plug
37. O-ring 16x2.65
38. Air plug
39. Screw, washer
40. Motor
46. Spring
- 47a. Bush
49. Impeller
- 50a. Diffuser
51. Shaft
55. Outer sleeve
63. O-ring retainer
64. Clamp plate
65. Screw M8x20, washer

CDLF 8,16

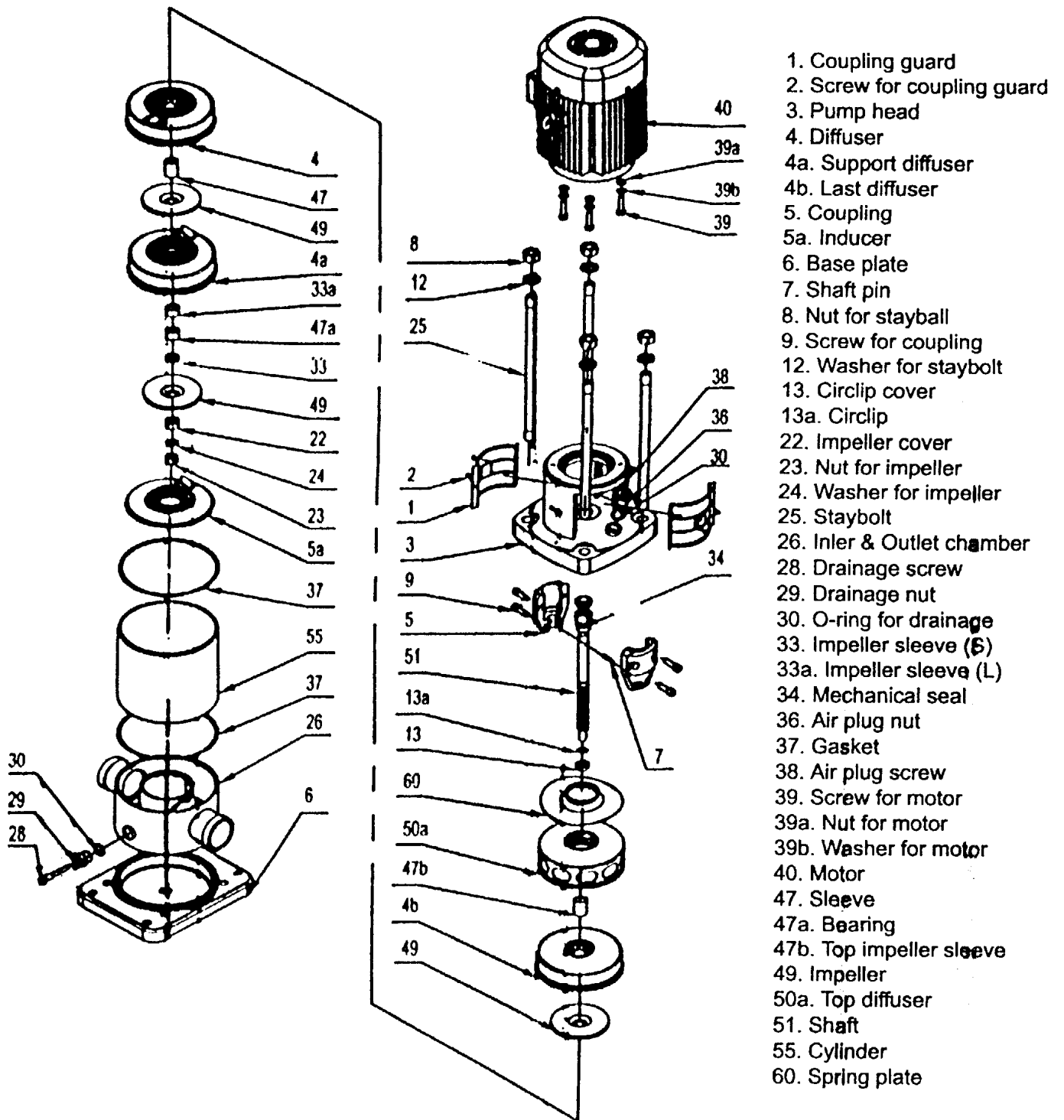

CDL 8,16 (Old Structure)

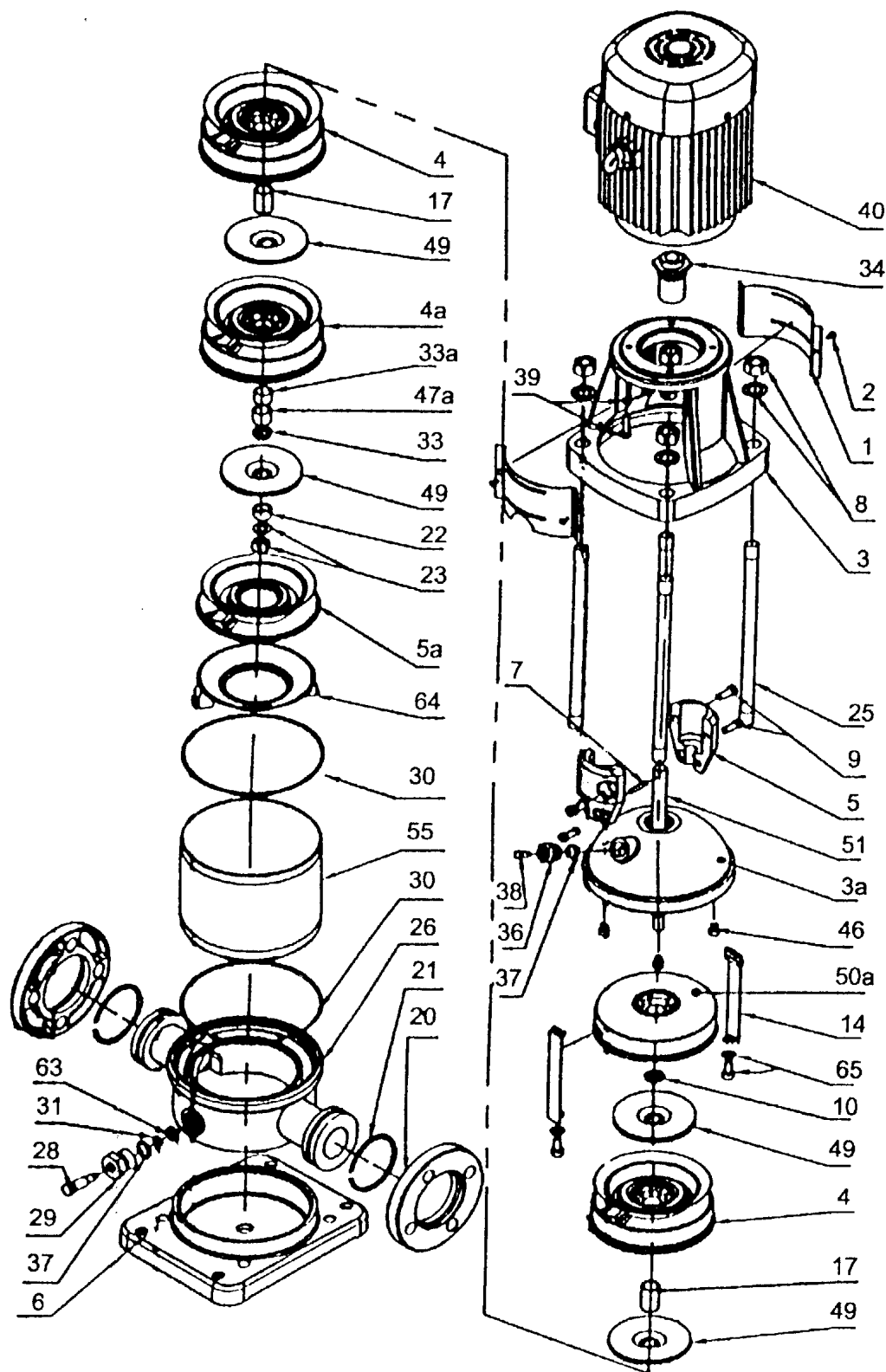

1. Protect cover
2. Screw M4x8
3. Pump head
- 3a. Lining
4. Diffuser
- 4a. Support diffuser
5. Coupling
- 5a. Inducer
6. Base plate
7. Pin
8. Nut M16, washer 16
9. Screw
10. Stop Ring
14. Straps
17. Sleeve1 21.5x17.5x43.64L
20. Flange
21. Circlip
22. Sleeve3 22x12.5x11
23. Nut M12, washer 12
24. Stay bolt
26. Suction & discharge
28. Drain bolt
29. Drain plug
30. O-ring (169x3,3)
31. O-ring (8x2.65)
33. Sleeve1 9.5x21.5x17.5
- 33a. Sleeve2 10x21.5x17.5
34. Mechanical seal (NJK-16)
36. Air release plug
37. O-ring (16x2.65)
38. Air plug M8x19L
39. Screw
46. Spring
- 47a. Bush
49. Impeller
- 50a. Diffuser
51. Shaft
55. Outer sleeve
63. Oring retainer
64. Clamp plate
65. Screw M8x20

CDLF 20

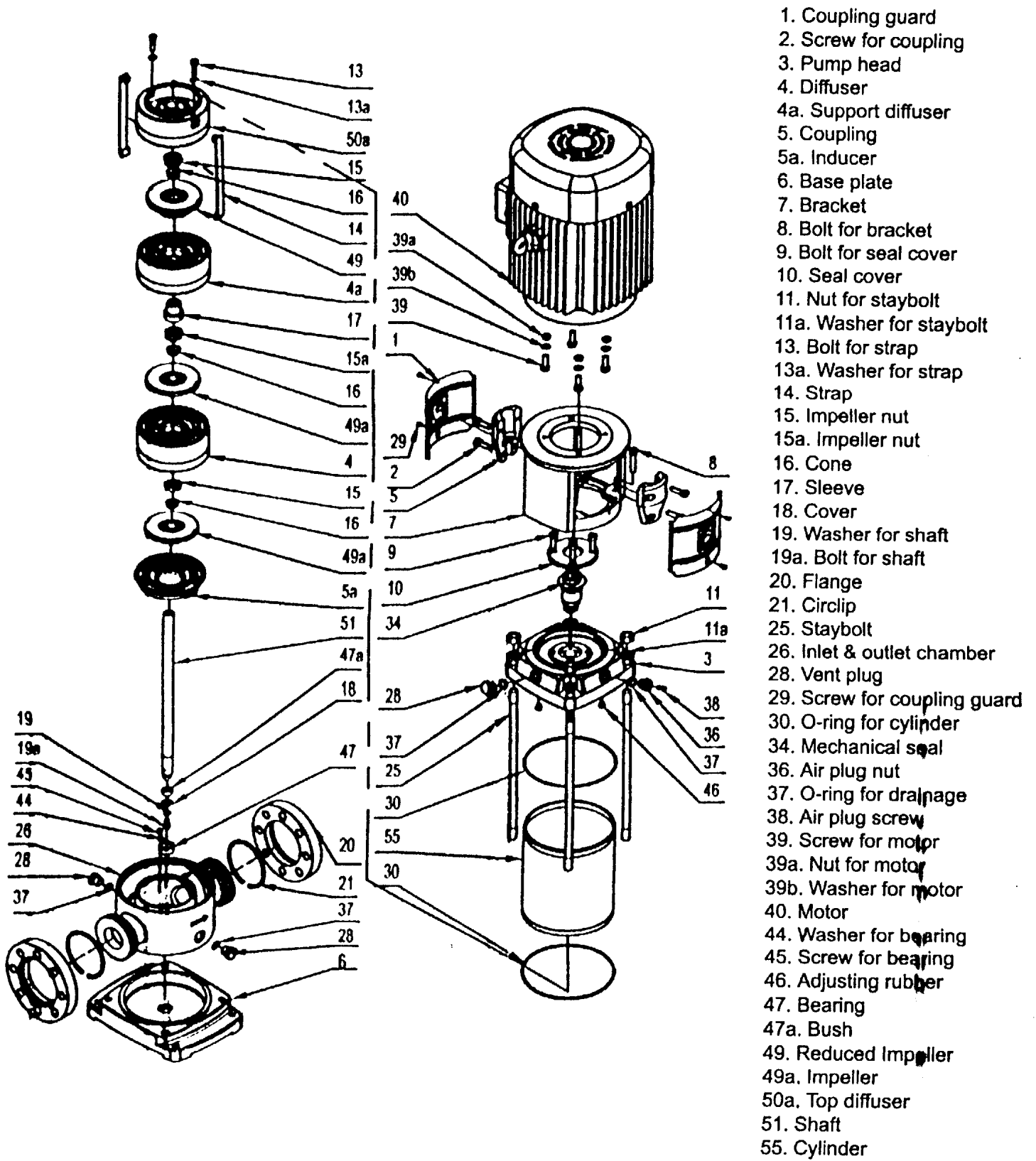

CDL(F) 32, 42, 65, 85